

## Technical Data Sheet

Chain actuator 230 V AC for: *roof windows, top hinged windows and bottom hinged windows*



### Technical Features

Operating voltage	230V AC $\pm$ 6%
Frequency	50 Hz
Stroke	200 mm / 250 mm
Thrust force and Tensile force	200 N
Current absorption	0,30 A
Speed	10 mm/s
Operating temperature	-10°/+40°
Operating time	4 min.
Limit switch closing-opening	Hall sensor Absorption
Protection degree	IP 20
Colour	Anodised Silver

### Dimensions

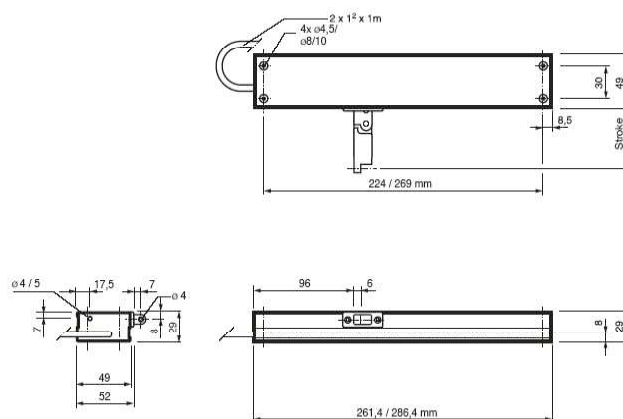

### Limits of use

The height of the frame must be at least: **600 mm**

The width of the frame must not exceed for each actuator **1500 mm**

The applied load must not exceed **200 N**

Check that the product is suitable for the environment planned

### Fixing accessories

